

FOR CNC MACHINE

OIL WATER SEPARATOR SUN-01

What are the hazards of deteriorated cutting fluid?

TOOL WEAR BACTERIAL REPRODUCTION CORROSION



1. In the process of machine tool processing, it is inevitable to mix lubricating oil, anti-rust oil and other impurities in the cutting fluid.
2. The increase of these impurities and oil slick will greatly promote the proliferation of microorganisms, accelerate the deterioration of cutting fluid, and shorten the service life of cutting fluid. This will directly affect the processing quality and tool life.
3. The deterioration and smells of cutting fluid will pollute surrounding environment and harm workers' health.

Effectively solve the deterioration of the cutting fluid and smell !

No worry about the interference of iron filings, regular cleaning and no consumables !

Extend the service life of cutting fluid and reduce production costs!

1-HOUR RUNNING EVERYDAY ! DISPOSE ONCE A WEEK ! 1 KWH EACH MONTH!



6 ADVANTAGES



Deep or shallow fluid
Dual-use oil inlet



Operating speed
Stepless adjustable



Overflow warning



Three-stage separation
Separate thoroughly



Timing control
1 kWh each month



Small size
Space saving

TECHNICAL SPECIFICATIONS

Input Voltage : AC 110/220V 50/60Hz	Work Period Setting : 16 Periods per Day
Input Power : 20W	Operating Speed : Stepless adjustable
Timing Range : 1min—168h	Oil Tank Capacity : 4L
Operating Temperature : 0℃--45℃	Net Weight : 13.2Kg
Overall Dimensions : 550*300*355 (545) mm	

PRACTICAL APPLICATION

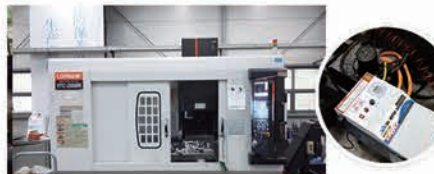

Model: Mazak VTC-200BN
Position: Right of the Machine



Model: Dalian Machine Tool VDL-600A
Position: Left of the Machine

LIVE-ACTION SHOOTING



CONTACT INFORMATION

LUOYANG XINCHENG PRECISION MACHINERY CO.,LTD

Web : www.brokentapremover.com

Tel : +86-0379-63512276

Email : tapremover@lyxc.com

Add : NO.256 East Tanggong Road, Luoyang, Henan, China



SUN-01 DEMO VIDEO



EDM-8C DEMO VIDEO



PORTABLE EDM BROKEN TAP REMOVER

SFX-4000B

EDM-8C



FOR CNC MACHINE

OIL WATER SEPARATOR

SUN-01



LUOYANG XINCHENG PRECISION MACHINERY CO.,LTD

SFX-4000B**M2-M36****EDM-8C****M2-M20****How to remove broken tap, drill, screw etc. out**

Method of removing tap about M2-M10



Method of removing tap about M12-M18

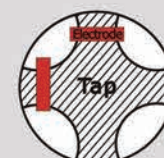

Method of removing tap about M20-M30

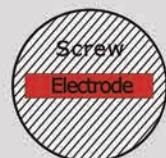

Method of removing screw about M6-M16

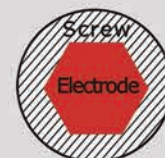

Method of removing screw about M10-M30

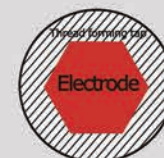

Method of removing thread forming tap above M10

Operation Skills

Vertical processing on big workpiece. Adsorb the stand directly on the workpiece, and build a diversion channel under the head to make coolant flow outside.

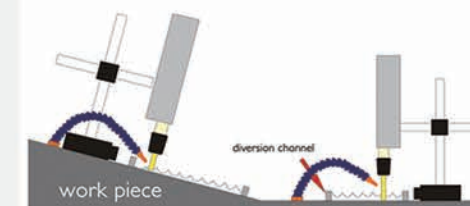

Choose desktop unit to fix the work-piece. It could process on small workpiece. Put the desktop unit into the tank to avoid the coolant losing.

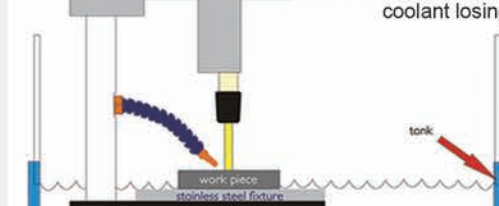

Magnetic base can adsorb on big workpiece directly, and the head position is adjustable.

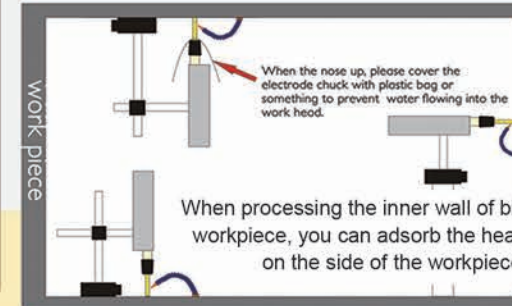
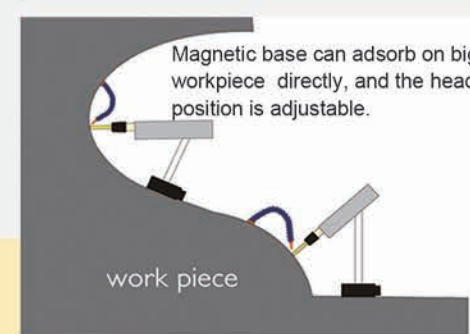

► Power source choices: 110V or 220V, 50HZ or 60HZ.

Specification

Model	EDM-8C	EDM-2000B	SFX-4000B
Basic Function			
Stepper Current	✓	✓	stepless adjusting
Depth setting, auto retract and alarm	✓	✓	✓
Accessories storage	Toolkit	one-in-box	one-in-box
Technical Parameter			
Input Power (w)	800	300~2000	300~3000
Electrode Holder Diameter (mm)	0.8~10	0.8~10	2~13
Working liquid	Tap water (Pure water/distilled water is better.)		
Max Process Depth of spindle servo (mm)	70	70	70
Short Hole Processing Speed (mm/min) Material: Quenched Steel	≈1 ElectrodeΦ4	ElectrodeΦ4 ≈1.5 ElectrodeΦ10 ≈1	ElectrodeΦ5 ≈2 ElectrodeΦ12 ≈1
Power Box Size(mm):	380*160*300	420*220*370	420*220*370
working head (mm)	DK8 315*50*50	DK8 315*50*50	DK8 315*50*50
Package Size (mm)	498*308*392	528*325*460	528*325*460
Net Weight (kg)	16	19	22

Company Strength

Factory aerial view



Workshop environment

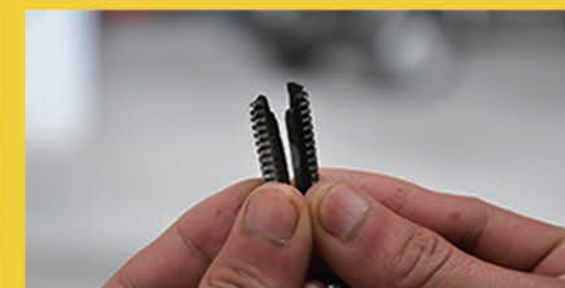

Production field

**Actual Field Processing Cases****Remove Broken Taps With Brass Strip****Drill Oilhole**